

Contact Points for Dial Gauges and Comparator Gauges

with male thread M 2.5

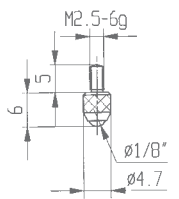

M2/70

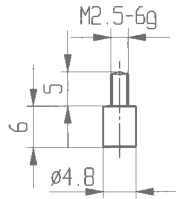

573/10

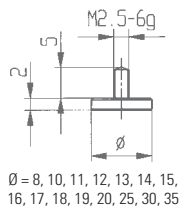

573/11

Ø = 8, 10, 11, 12, 13, 14, 15, 16, 17, 18, 19, 20, 25, 30, 35

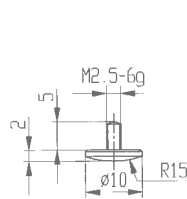

573/12

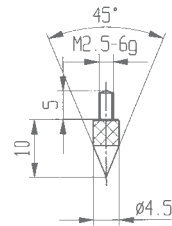

573/13

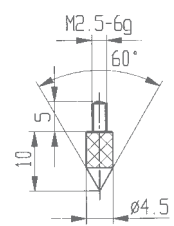

573/13-60

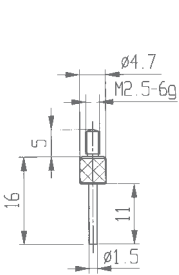

573/14

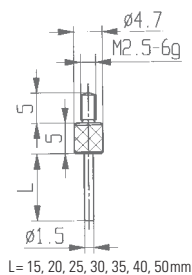

573/14 L

L = 15, 20, 25, 30, 35, 40, 50 mm

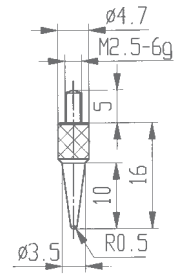

573/15

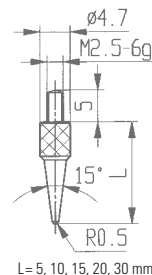

573/15 L

L = 5, 10, 15, 20, 30 mm

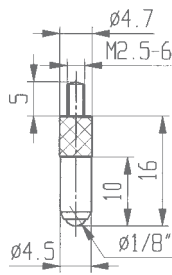

573/16

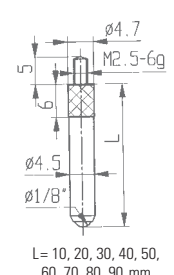

573/17 L

L = 10, 20, 30, 40, 50, 60, 70, 80, 90 mm

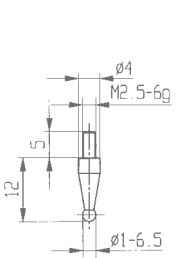

573/18

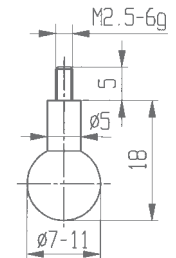

573/19

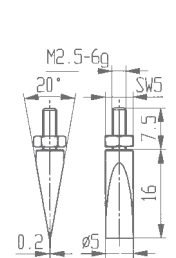

573/20 E

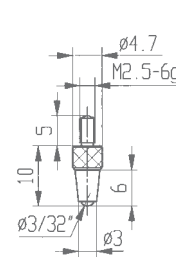

573/21

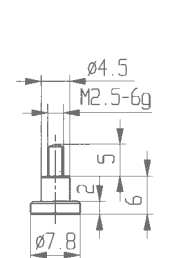

573/22

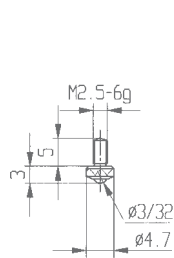

573/23

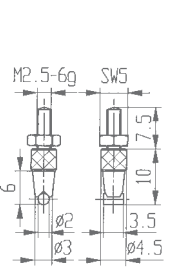

573/24 E

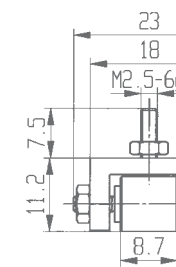

573/25 E

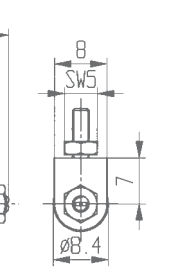

573/27 E

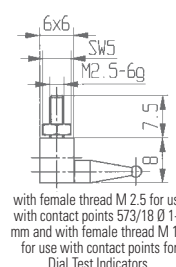

573/28 E

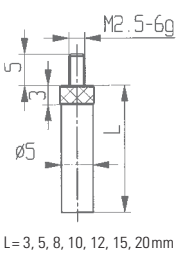
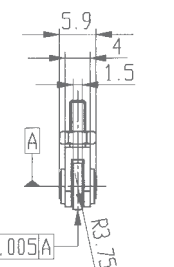
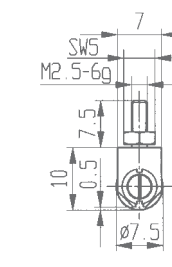

573/29 L

L = 3, 5, 8, 10, 12, 15, 20 mm

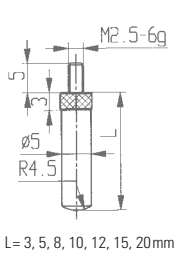

573/30 L

L = 3, 5, 8, 10, 12, 15, 20 mm

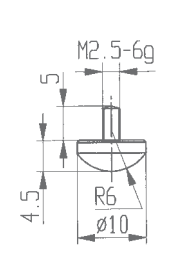

573/32

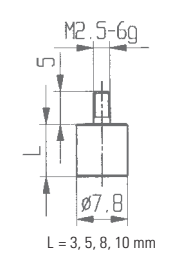

573/35 L

L = 3, 5, 8, 10 mm

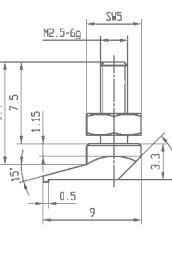

573/39 E

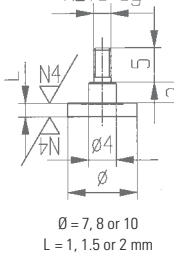

573/40-D-L

Ø = 7, 8 or 10
L = 1, 1.5 or 2 mm

Contact Point Extensions

Contact Points with carbide (H) or ceramic (C) insert

Contact Points with balls from ruby (R), sapphire (S) or plastic (KU)

with male thread M 2.5

Contact Point Extensions:

Dimension A: 4 mm (used at Dial Gauges with spindle \varnothing of 4 mm)

Dimension A: 5 mm (used at Dial Gauges with spindle \varnothing of 5 mm)

Dimension B available in the following standard lengths: 10, 15, 90, 95 and 100 mm

Custom lengths are available.

Contact Points with carbide (H), ruby (R), sapphire (S), ceramic (C), or plastic (KU) inserts

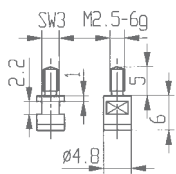
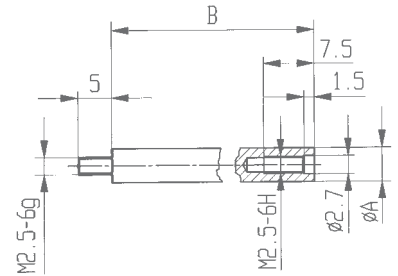

573/10 H

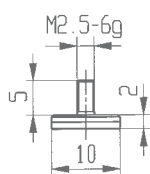

573/11 H/C

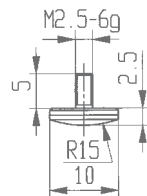

573/12 H/C

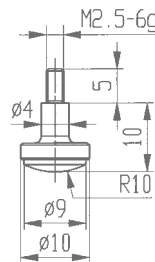

573/12-10 H

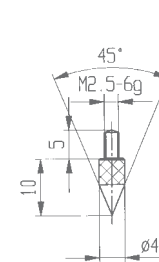

573/13 H

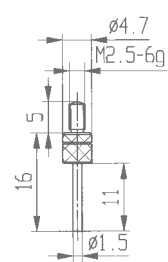

573/14 H

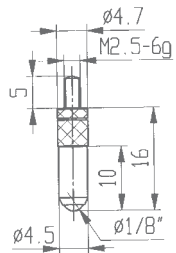

573/16 H/R/S

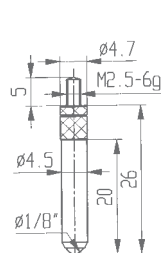

573/17 H/R/S

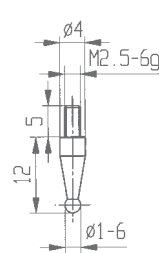

573/18 H

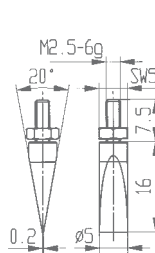

573/20 HE

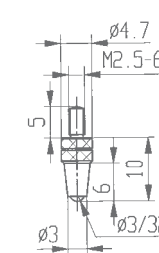

573/21 H

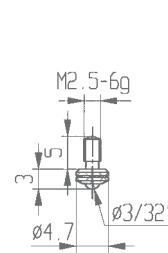

573/23 H

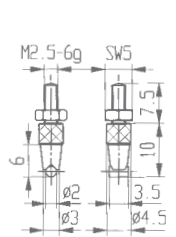

573/24 HE

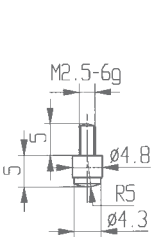

573/31 H

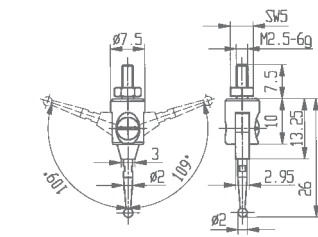

573/33 HE

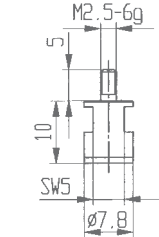

573/35 H

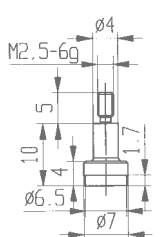

573/102 H

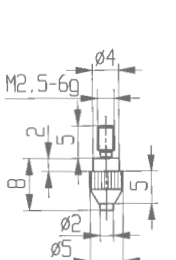

573/105 H

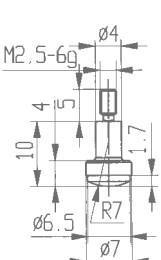

573/108 H

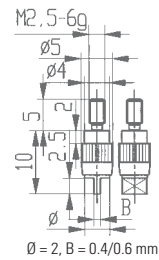

$\varnothing = 2, B = 0.4/0.6 \text{ mm}$
 $\varnothing = 4, B = 1 \text{ mm}$

573/110 H

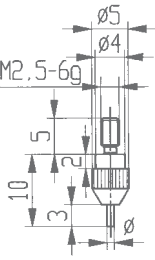

$\varnothing = 0.45, 1.0 \text{ mm}$

573/112 H

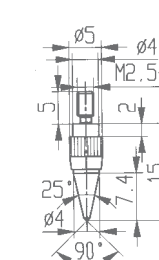

573/114 H

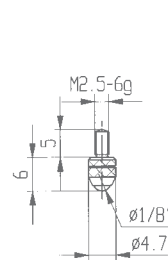

M 2/70 H/R/S/C/KU

Steel contact points (Z) for Dial Gauges and Comparator Gauges
Carbide (HZ) and ruby (RZ) contact points
with 4/48 male threads

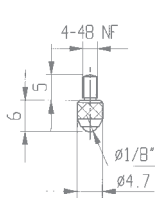

M2/70 Z

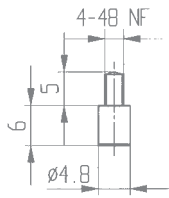

573/10 Z

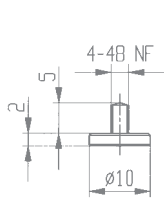

573/11 Z

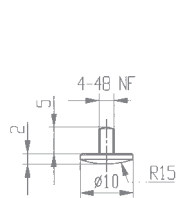

573/12 Z

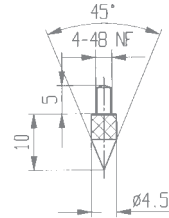

573/13 Z

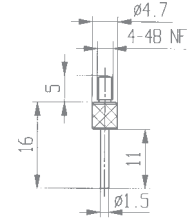

573/14 Z

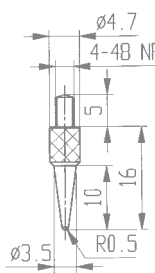

573/15 Z

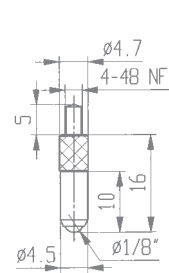

573/16 Z

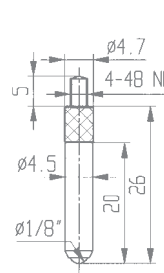

573/17 Z

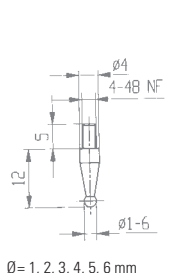

573/18 Z

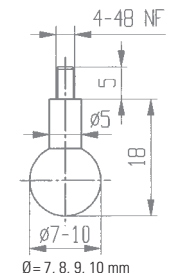

573/19 Z

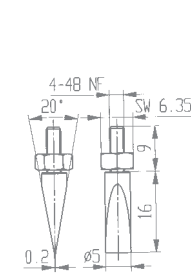

573/20 ZE

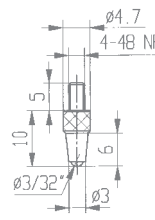

573/21 Z

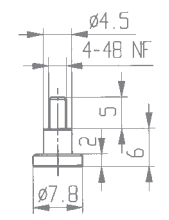

573/22 Z

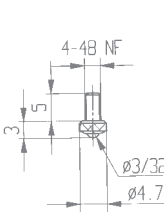

573/23 Z

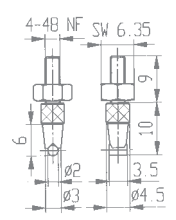

573/24 ZE

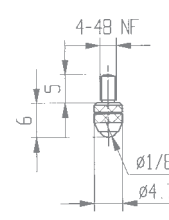

M2/70 HZ

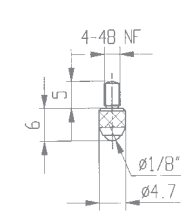

M2/70 RZ/SZ

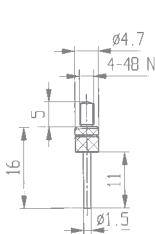

573/14 HZ

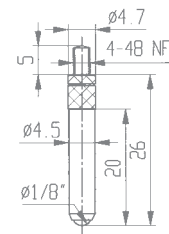

573/17 HZ

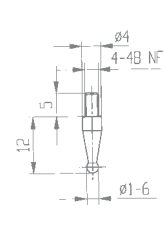

573/18 HZ

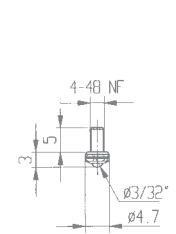

573/23 HZ

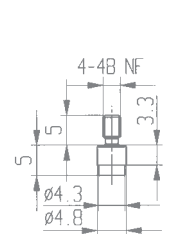

573/101 HZ

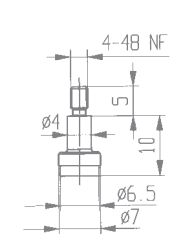

573/102 HZ

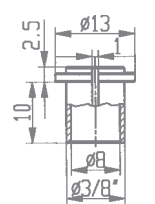

Adapter 62168

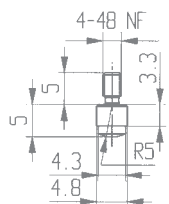

573/107 HZ

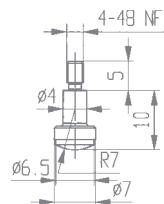

573/108 HZ

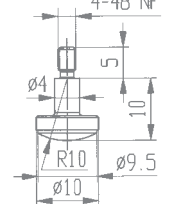

573/109 HZ

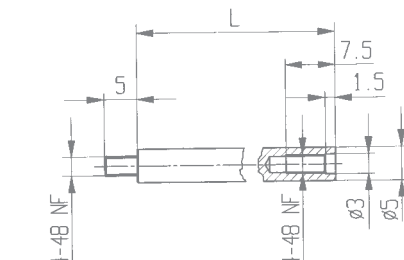

Contact Point Extensions

Dimension L, available in the following standard lengths: 1", 2", 3" and 4". Custom lengths are available.